

**ORDINANCE 20-OZ-32** amending the Zoning Ordinance and the Zoning Map of the City of Murfreesboro, Tennessee, as heretofore amended and as now in force and effect, to rezone approximately 0.66 acres located at 206 Dill Lane from Single-Family Residential Fifteen (RS-15) District to Single-Family Residential Eight (RS-8) District; The Journey Home, Inc., applicant [2020-410].

**BE IT ORDAINED BY THE CITY COUNCIL OF THE CITY OF MURFREESBORO, TENNESSEE, AS FOLLOWS:**

SECTION 1. That the same having been heretofore recommended to the City Council by the City Planning Commission, the Zoning Ordinance and the Zoning Map of the City of Murfreesboro, Tennessee, as herein referred to, adopted and made a part of this Ordinance as heretofore amended and as now in force and effect, be and the same are hereby amended so as to rezone the territory indicated on the attached map.

SECTION 2. That, from and after the effective date hereof, the area depicted on the attached map shall be zoned and approved as Single-Family Residential Eight (RS-8) District, as indicated thereon, and shall be subject to all the terms and provisions of said Ordinance applicable to such districts. The City Planning Commission is hereby authorized and directed to make such changes in and additions to said Zoning Map as may be necessary to show thereon that said area of the City is zoned as indicated on the attached map. This zoning change shall not affect the applicability of any overlay zone to the area.

SECTION 3. That this Ordinance shall take effect fifteen (15) days after its passage upon second and final reading, the public welfare and the welfare of the City requiring it.

Passed:

1<sup>st</sup> reading October 22, 2020  
2<sup>nd</sup> reading November 5, 2020

  
Shane McFarland, Mayor

ATTEST:

  
Melissa B. Wright  
City Recorder

APPROVED AS TO FORM:

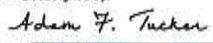
DocuSigned by:  
  
Adam F. Tucker  
City Attorney



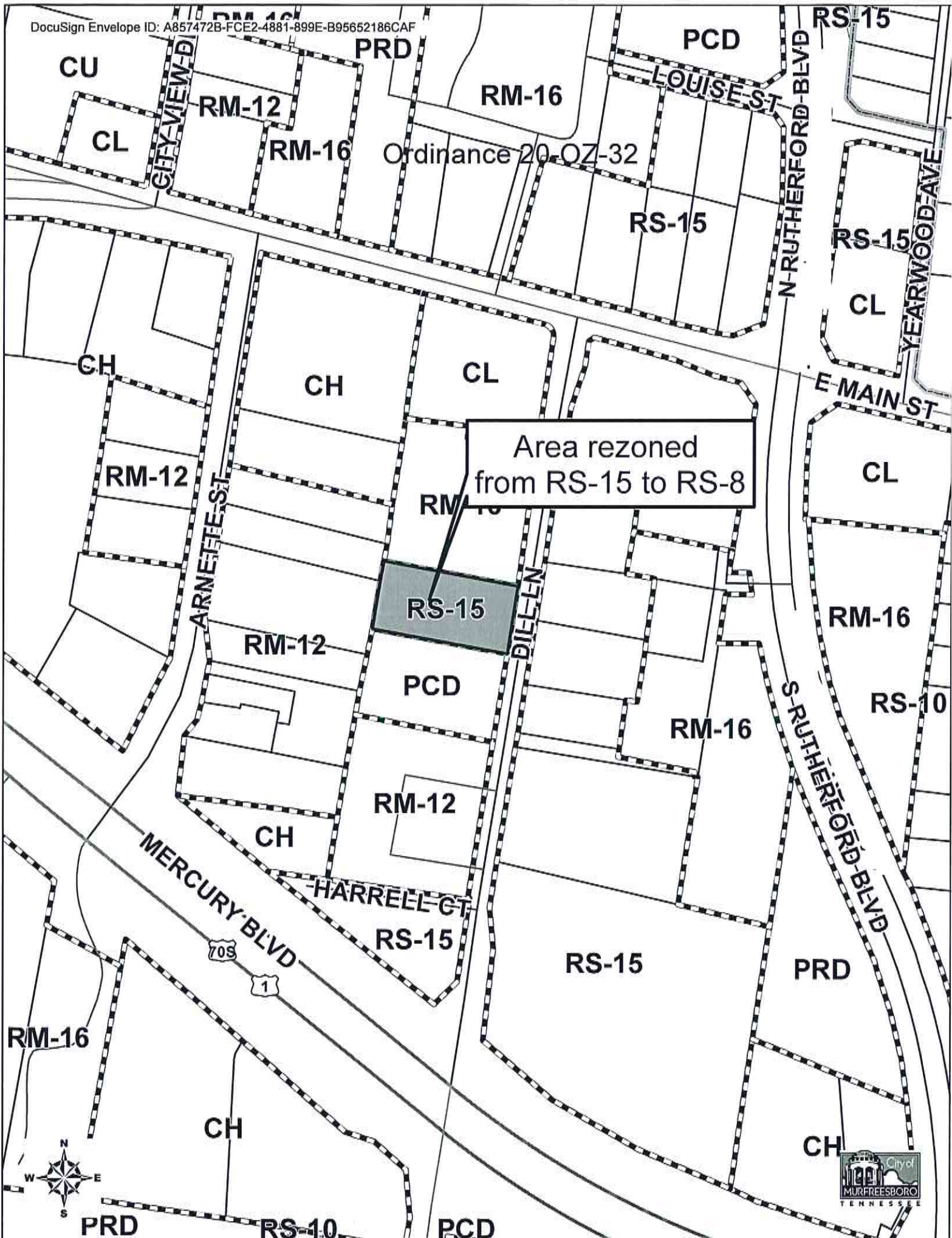

Area rezoned  
from RS-15 to RS-8

RS-15

RS-15

PCD

PRD

CU

RM-16

RM-12

LOUISE ST

CL

RM-16

Ordinance 20-OZ-32

RS-15

RS-15

CL

YEARWOOD-AVE

CH

CH

CL

E-MAIN ST

CL

RM-12

RM-16

RM-16

RM-12

PCD

RM-16

RS-10

S-RUTHERFORD-BLVD

RM-12

CH

MERCURY BLVD

HARRELL-GT

RS-15

RS-15

PRD

RM-16

CH

CH

PRD

RS-10

PCD

