

**ORDINANCE 16-OZ-54** amending the Zoning Ordinance and the Zoning Map of the City of Murfreesboro, Tennessee, as heretofore amended and as now in force and effect, to rezone approximately 8 acres along South Rutherford Boulevard from Single-Family Residential Ten (RS-10) District to Residential Zero Lot-Line (RZ) District; Swanson Development, applicant [2016-451].

**BE IT ORDAINED BY THE CITY COUNCIL OF THE CITY OF MURFREESBORO, TENNESSEE, AS FOLLOWS:**

SECTION 1. That the same having been heretofore recommended to the City Council by the City Planning Commission, the Zoning Ordinance and the Zoning Map of the City of Murfreesboro, Tennessee, as herein referred to, adopted and made a part of this Ordinance as heretofore amended and as now in force and effect, be and the same are hereby amended so as to rezone the territory indicated on the attached map.

SECTION 2. That, from and after the effective date hereof, the area depicted on the attached map shall be zoned and approved as Residential Zero Lot-Line (RZ) District, as indicated thereon, and shall be subject to all the terms and provisions of said Ordinance applicable to such districts. The City Planning Commission be and it is hereby authorized and directed to make such changes in and additions to said Zoning Map as may be necessary to show thereon that said area of the City is zoned as indicated on the attached map. This zoning change shall not affect the applicability of any overlay zone to the area.

SECTION 3. That this Ordinance shall take effect fifteen (15) days after its passage upon second and final reading, the public welfare and the welfare of the City requiring it.

Passed:

1<sup>st</sup> reading November 17, 2016

2<sup>nd</sup> reading December 1, 2016

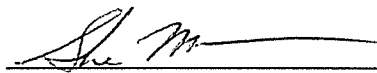
  
\_\_\_\_\_  
Shane McFarland, Mayor

ATTEST:

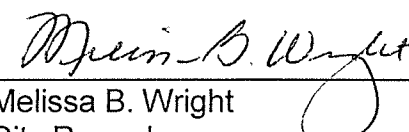
  
\_\_\_\_\_  
Melissa B. Wright  
City Recorder

APPROVED AS TO FORM:

  
\_\_\_\_\_  
Craig D. Tindall  
City Attorney

SEAL



RUTHERFORD ST

O BRIEN DR

PRD

Area  
Rezoned from  
RS-10 to RZ

ASPEN AVE

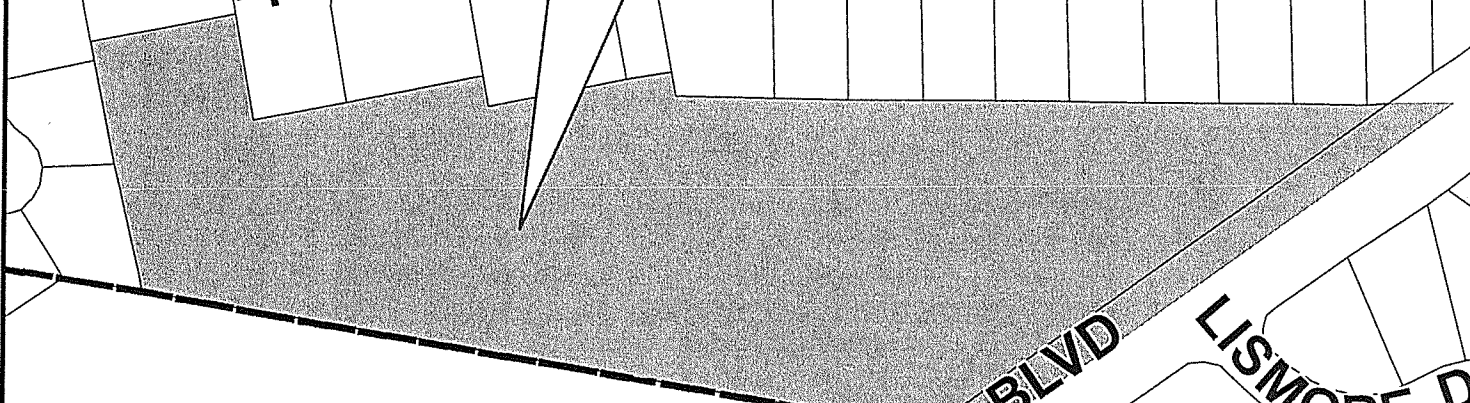

LISMORE DR

RM-12

S RUTHERFORD BLVD

ANNEX CT

PUD

ARROW CT

FLOYD AVE

99

CH

CF

WILLOW DR



Ordinance 16-OZ-54